

20' ELITE OFFICE CONTAINER WITH INTEGRATED RESTROOM



FEATURES

The Elite Office Container with Integrated Restroom encompasses all the standard features of our 20' Office container, in addition to the following upgrades:

1. STRUCTURAL INTEGRITY

Made with 2" Structural Insulated Panel walls having Fiberglass Reinforced Plastic (FRP) Skins.

2. RESTROOM FACILITIES

Contains a single stall restroom, complemented by a stainless steel sink and mirror.

3. WINDOWS

Features windows on both sides, equipped with high-security window screens.

4. FLOORING

Installed with Durable Luxury Vinyl Plank (LVP) flooring.

5. CLIMATE CONTROL

Comes with a 12K BTU AC unit and a wall heater.

6. LIGHTING

Fitted with LED ceiling light strips and an entrance light.

7. FURNITURE OPTIONS

Built-in desk, available in select locations.



866.459.7600
mobilemodularcontainers.com

**mobile
modular**
Portable Storage

20' ELITE OFFICE CONTAINER WITH INTEGRATED RESTROOM



Expert advice from the same team you have come to trust for your modular solutions. Mobile Modular offers Portable Storage for rent, lease or purchase. Available in 20ft or 40ft length, our containers are made to be convenient, safe and secure for all your portable space needs.

SPECIFICATIONS

Exterior Dimensions	20' x 8' W x 8' 6" H
Interior Dimensions	38' 6" L x 7' 4" W x 7' 6" H
Tare Weight	5,500 pounds
Maximum payload	47,710 pounds
Maximum weight	52,910 pounds
Straight line	60 ft clearance
Height required	14 ft

FLOOR PLAN

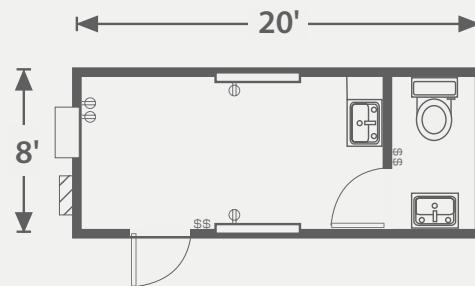

LEGEND			
HVAC	Panel Box	Outlet/Receptacle	Light Switch

All dimensions are nominal.

FOR RENT, LEASE AND PURCHASE

- Variety of office and storage plans
- Well-maintained new and refurbished units
- Streamlined ordering process
- Reliable delivery and pick-up

866.459.7600
mobilemodularcontainers.com

